



R.E. PURVIS & Associates, Inc.

6667 W. Old Shakopee Rd.
Bloomington, MN 55438

(952) 829-5532
(952) 829-5838 fax

BACK-UP, SOLID
MS27595 STYLE

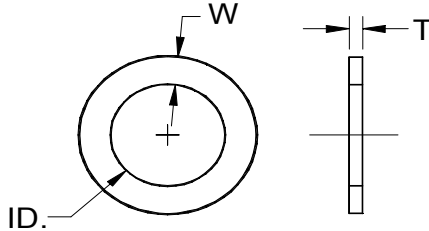

Solid Back-Up Rings MS 27595 Style					Solid Back-Up Rings MS 27595 Style				
Dash#	ID	Tol.	T Thickness	W Wall	Dash#	ID	Tol.	T Thickness	W Wall
004	.080				121	1.065			
005	.111				122	1.127			
006	.125				123	1.190			
007	.156				124	1.252			
008	.187	+/- .001			125	1.315			
009	.219				126	1.377			
010	.250				127	1.440			
011	.312				128	1.502			
012	.375				129	1.565			
013	.440				130	1.629			
014	.503				131	1.691			
015	.565		.052/.048	.056/.054	132	1.754			
016	.628				133	1.816			
017	.690				134	1.879	+/- .002	.052/.048	.089/.087
018	.753				135	1.942			
019	.815				136	2.004			
020	.881				137	2.067			
021	.943				138	2.129			
022	1.006				139	2.192			
023	1.068				140	2.254			
024	1.131	+/- .002			141	2.317			
025	1.193				142	2.379			
026	1.256				143	2.442			
027	1.318				144	2.504			
028	1.381				145	2.567			
110	.374				146	2.629			
111	.437				147	2.692			
112	.499				148	2.754			
113	.562				149	2.817			
114	.624				210	.753			
115	.687	+/- .001	.052/.048	.089/.087	211	.815			
116	.749				212	.878	+/- .001		
117	.815				213	.940		.052/.048	.120/.118
118	.877				214	1.003			
119	.940				215	1.065	+/- .002		
120	1.002				216	1.128			

[E-mail address: sales@repurvis.com](mailto:sales@repurvis.com)

BACK-UP, SOLID
MS27595 STYLE

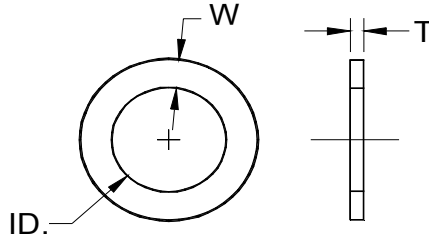

Solid Back-Up Rings MS 27595 Style					Solid Back-Up Rings MS 27595 Style				
Dash#	ID	tol.	T Thickness	W Wall	Dash#	ID	tol.	T Thickness	W Wall
217	1.190				340	3.373			
218	1.253				341	3.498			
219	1.315				342	3.623			
220	1.378	+/- .002	.052/.048	.120/.118	343	3.748			
221	1.440				344	3.873			
222	1.503				345	3.998	+/- .002	.075/.071	.186/.184
223	1.629				346	4.123			
224	1.754				347	4.248			
225	1.880				348	4.373			
226	2.005				349	4.498			
227	2.130				425	4.502			
228	2.255				426	4.627			
229	2.380				427	4.752			
230	2.505				428	4.877			
231	2.630				429	5.002			
232	2.755				430	5.127			
233	2.880				431	5.252			
234	3.005				432	5.377			
235	3.130				433	5.502			
236	3.255				434	5.627			
237	3.380				435	5.752			
238	3.505				436	5.877			
239	3.630				437	6.002			
240	3.755				438	6.252			
241	3.880				439	6.502			
242	4.005				440	6.752	+/- .002	.110/.106	.237/.235
243	4.130				441	7.002			
244	4.255				442	7.252			
245	4.380				443	7.502			
246	4.505				444	7.752			
247	4.630				445	8.002			
325	1.497				446	8.502			
326	1.622				447	9.002			
327	1.748				448	9.502	+/- .003		
328	1.873				449	10.002			
329	1.998				450	10.502			
330	2.123				451	11.002			
331	2.248				452	11.502			
332	2.373				453	12.002	+/- .004		
333	2.498				454	12.502			
334	2.623				455	13.002			
335	2.748	+/- .002	.075/.071	.186/.184	456	13.502			
336	2.873				457	14.002			
337	2.998				458	14.502	+/- .005		
338	3.123				459	15.002			
339	3.248				460	15.502			

Standard Materials: Virgin PTFE(3500 psi), 15% Glass Filled(4500 psi), 25% Glass filled(5500 psi+)
 Alternate Materials: GF Nylon, 6/6 Nylon, Ertalyte, PPS, Carbon filled PTFE.
 Alternate Sizes: Custom diameters and profiles.
 Requests for back-up rings for applications over 3500 psi may require a design review.
 Pro-E Design software. We can read any file type.