

ALJM / ALJML

3-PIECE, MALE ALUMINUM SERIES / PTFE LINERS AVAILABLE

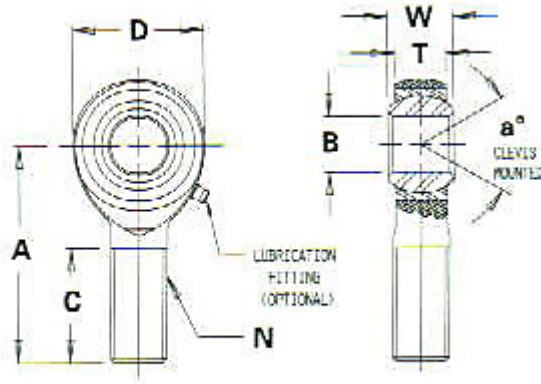

MATERIALS

BALL

52100 Steel
Rc 56 MIN.
HARD CHROME
PLATED

RACE

STEEL ALLOY
HEAT TREATED
ZINC PLATED
CHROMATE
TREATED

BODY

ALUMINUM
7075-T6
HARD ANODIZED RED

ALJM - ALUMINUM SERIES

MALE ROD ENDS		B DIA.	D DIA.	W WIDTH	T WIDTH	BALL DIA.	A LGTH	N THD.	C LGTH	a MIS. ANGLE	ULT. STATIC RADIAL LOAD (lbs)	APPROX. WEIGHT (lbs)
RIGHT HAND PART NO.	LEFT HAND PART NO.	+0.0015 -0.0005	+0.010 -0.010	+0.000 -0.005	+0.000 -0.005	REF.	+0.015 -0.015	UNF 3A	+0.062 -0.031	REF.		
ALJM3	ALJML3	.1900	.625	.312	.250	.437	1.250	10-32	.750	13	1,360	.022
ALJM4	ALJML4	.2500	.750	.375	.281	.500	1.562	1/4-28	1.000	16	2,465	.034
ALJM5	ALJML5	.3125	.875	.437	.344	.625	1.875	5/16-24	1.250	14	2,850	.050
ALJM6	ALJML6	.3750	1.000	.500	.406	.719	1.938	3/8-24	1.250	12	4,208	.078
ALJM7	ALJML7	.4375	1.125	.562	.437	.812	2.125	7/16-20	1.375	14	4,534	.091
ALJM8	ALJML8	.5000	1.312	.625	.500	.937	2.438	1/2-20	1.500	12	7,698	.140
ALJM10	ALJML10	.6250	1.500	.750	.562	1.125	2.625	5/8-18	1.625	16	8,516	.240
ALJM10H	ALJML10H	.6250	1.750	.750	.562	1.125	2.625	5/8-18	1.625	16	16,000	.268
ALJM12	ALJML12	.7500	1.750	.875	.687	1.31	2.875	3/4-16	1.750	14	13,319	.300

Notes: For studs add "Y" to suffix

For teflon liner add "T" to suffix

EXAMPLE: ALJM4Y

EXAMPLE: ALJM5T