

CMX/CMXL

2-PIECE METAL TO METAL, HEAT TREATED, ALLOY STEEL

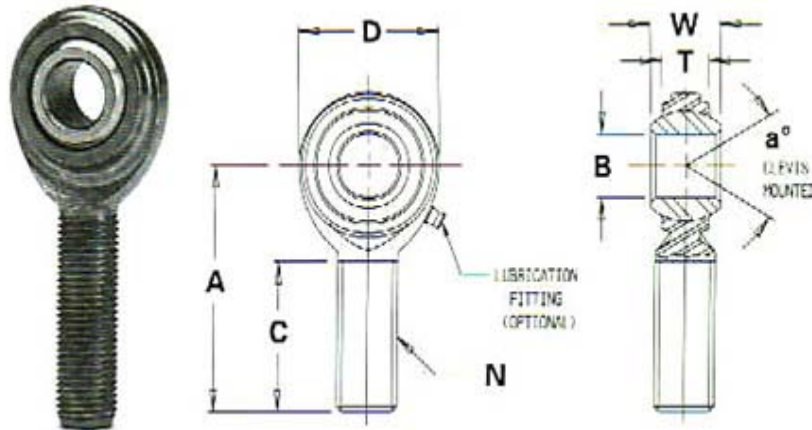

MATERIALS

BALL
52100 Steel Rc 56 MIN. HARD CHROME PLATED

BODY
ALLOY STEEL HEAT TREATED BLACK OXIDE OR BLACK ZINC PLATED

MALE ROD ENDS		B DIA.	D DIA.	W WIDTH	T WIDTH	BALL DIA.	A LGTH	N THD.	C LGTH	a MIS. ANGLE	ULT. STATIC RADIAL LOAD (lbs)	APPROX. WEIGHT (lbs)
RIGHT HAND PART NO.	LEFT HAND PART NO.	+0.0015 -0.0005	+0.010 -0.010	+0.005 -0.005	REF.	REF.	+0.015 -0.015	UNF 3A	+0.062 -0.031	REF.		
CMX8	CMXL8	.5000	1.312	.625	.453	.937	2.438	1/2-20	1.500	20	17,000	.24
CMX10-8	CMXL10-8	.5000	1.500	.750	.484	1.125	2.625	5/8-18	1.625	20	18,000	.30
CMX10	CMXL10	.6250	1.500	.750	.484	1.125	2.625	5/8-18	1.625	26	18,000	.36
CMX12-8	CMXL12-8	.5000	1.750	.875	.593	1.312	2.875	3/4-16	1.750	26	25,000	.57
CMX12-10	CMXL12-10	.6250	1.750	.875	.593	1.312	2.875	3/4-16	1.750	26	25,000	.57
CMX12	CMXL12	.7500	1.750	.875	.593	1.312	2.875	3/4-16	1.750	24	25,000	.57

MALE ROD END LOAD RATINGS BASED ON NO LUBRICATING FITTING. FOR LOAD RATING WITH LUBRICATOR, PLEASE CONTACT THE FK. ENGINEERING DEPARTMENT.

SPECIAL PRODUCTS

SPECIAL PRODUCTS

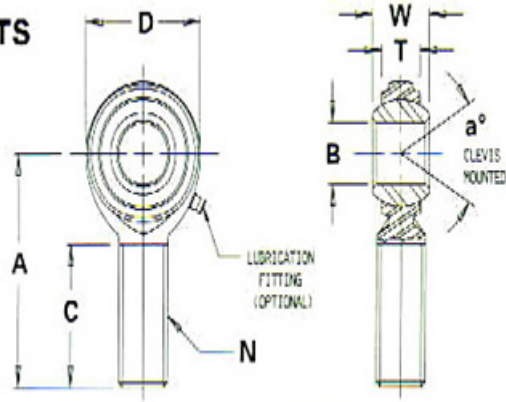

MATERIALS

BALL	BODY
52100 Steel Rc 56 MIN. HARD CHROME PLATED	LOW CARBON STEEL ZINC PLATED CHROMATE TREATED

MALE ROD ENDS		B DIA.	D DIA.	W WIDTH	T WIDTH	BALL DIA.	A LGTH	N THD.	C LGTH	ULT. STATIC RADIAL LOAD (lbs)
RIGHT HAND PART NO.	LEFT HAND PART NO.	+0.0025 -0.0005	+0.010 -0.010	+0.005 -0.005	REF.	REF.	+0.015 -0.015	UNF 2B	+0.062 -0.031	
CM4-3	CML4-3	.1900	.750	.375	.250	.500	1.562	1/4-28	1.000	2,225
CM5-4	CML5-4	.2500	.875	.437	.312	.625	1.875	5/16-24	1.250	3,600
CM6-5	CML6-5	.3125	1.000	.500	.359	.719	1.938	3/8-24	1.250	5,100
CM8-6	CML8-6	.3750	1.312	.625	.453	.937	2.438	1/2-20	1.500	8,386
CM10-8	CML10-8	.5000	1.500	.750	.484	1.125	2.625	5/8-18	1.625	9,813
CM12-8	CML12-8	.5000	1.750	.875	.593	1.312	2.875	3/4-16	1.750	14,290
CM10-12Z	CML10-12Z	.6250	1.750	.875	.593	1.312	2.875	5/8-18	1.750	*
CM12-757	CML12-757	.7570	1.750	.875	.593	1.312	2.875	3/4-16	1.750	14,290