

FKS / FKS-T

HEAVY DUTY PRECISION, ALLOY STEEL / PTFE LINERS AVAILABLE

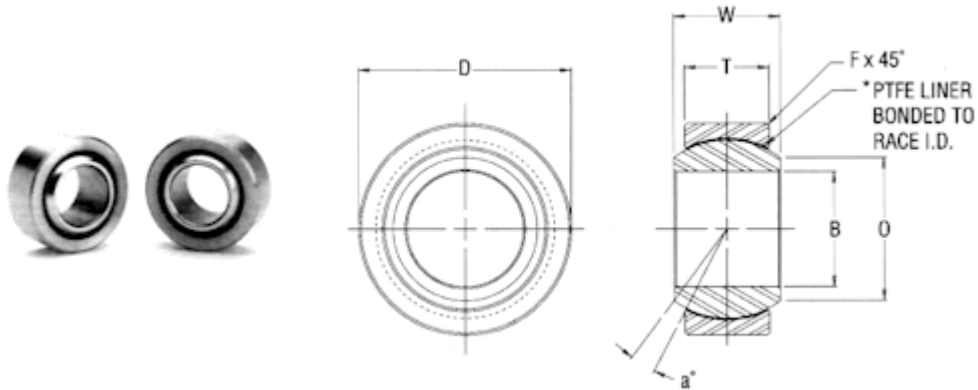

BEARING PART NO.	B DIA.	D DIA.	W WIDTH	T WIDTH	O DIA.	BALL DIA.	F CHAMBER	^a MIS. ANGLE	ULT. STATIC RADIAL LOAD (lbs)	APPROX. WEIGHT (lbs)
	+0.000 -0.005	+0.000 -0.005	+0.000 -0.005	+0.000 -0.005	REF.	REF.	REF.	REF.		
FKS3	.1900	.5625	.281	.218	.293	.406	.015	11	5,400	.014
FKS4	.2500	.6562	.343	.250	.364	.500	.022	13.5	8,400	.022
FKS5	.3125	.7500	.375	.281	.419	.562	.032	12	11,600	.065
FKS6	.3750	.8125	.406	.312	.516	.656	.032	10	15,600	.038
FKS7	.4375	.9062	.437	.343	.530	.687	.032	8	22,300	.047
FKS8	.5000	1.0000	.500	.390	.600	.781	.032	9.5	26,900	.065
FKS9	.5625	1.0937	.562	.437	.671	.875	.032	9.5	36,000	.086
FKS10	.6250	1.1875	.625	.500	.739	.968	.032	8.5	40,000	.110
FKS12	.7500	1.4375	.750	.593	.920	1.187	.044	9	78,000	.204
FKS14	.8750	1.5625	.875	.703	.980	1.312	.044	9.5	86,000	.263
FKS16	1.000	1.7500	1.000	.797	1.118	1.500	.044	10	104,000	.386

MATERIALS	
BALL	RACE
52100 STEEL HEAT TREATED CHROME PLATED	ALLOY STEEL HEAT TREATED OIL COATED

NOTES: 1. LUBRICATION GROOVES IN I.D. & O.D. OF RACE

2. FOR TEFLON LINER ADD "T" TO SUFFIX.

EXAMPLE: FKS8T

(UNITS WITH PTFE LINERS HAVE NO LUBRICATION HOLES OR GROOVES IN RACE.)