

HRSMX-T / HIN-T

HIGH MISALIGNMENT SERIES - MALE ROD ENDS AND SPHERICAL BEARINGS - HEAVY DUTY

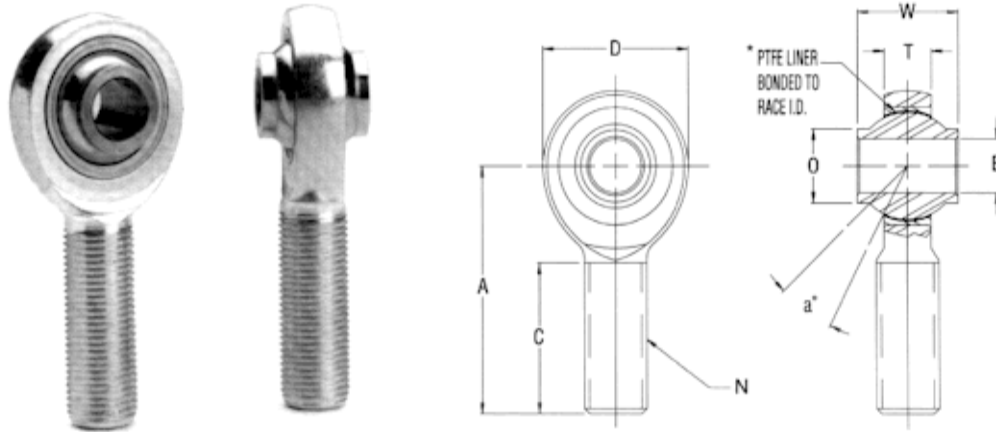

MALE ROD ENDS		B DIA.	D DIA.	W WIDTH	T WIDTH	BALL DIA.	A LGTH	N THD.	C LGTH	O DIA.	a MIS. ANGLE	ULT. STATIC RADIAL LOAD (lbs)	APPROX. WEIGHT (lbs)
RIGHT HAND PART NO.	LEFT HAND PART NO.	+.0000 -.0005	+.010 -.010	+.000 -.005	+.005 -.005	REF.	+.015 -.015	UNF 3A	+.031 -.031	REF.	REF.		
HRSMX6T	HRSMXL6T	.3750	1.150	.813	.355	.781	2.125	7/16-20	1.281	.512	22	11,789	.068
HRSMX7T	HRSMXL7T	.4375	1.337	.875	.355	.875	2.438	1/2-20	1.468	.618	21	17,100	.095
HRSMX8T	HRSMXL8T	.5000	1.525	.937	.411	1.000	2.625	5/8-18	1.562	.730	19	23,703	.160
HRSMX10T	HRSMXL10T	.6250	1.775	1.200	.577	1.250	2.875	3/4-16	1.687	.856	19	32,100	.245
HRSMX12T	HRSMXL12T	.7500	2.025	1.280	.630	1.375	3.375	7/8-14	2.000	.970	18	38,701	.315

*Grease fittings are not supplied on these sizes. Male Rod End load ratings based on no lubricating fitting.

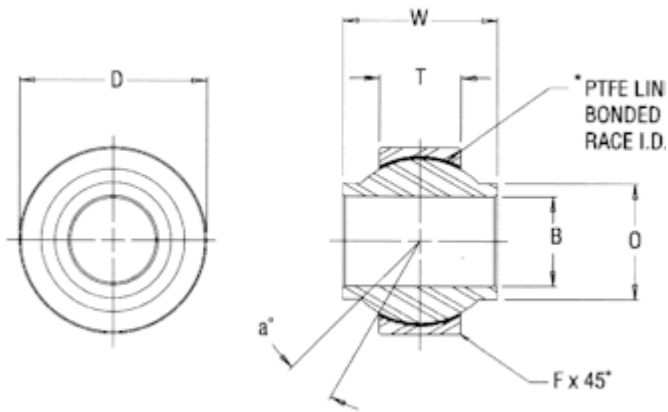

MATERIALS

BALL

52100
STEEL
Rc. 56
MIN.HARD
CHROME
PLATED

RACE

STEEL
ALLOY
ZINC
PLATED
CHROMATE
TREATED

BODY

4340 STEEL,
HEAT TREATED
ZINC PLATED
CHROMATE TREATED

LINER

*TEFLON FABRIC

BEARING NO.	B DIA.	D DIA.	W WIDTH	T WIDTH	O DIA.	BALL DIA.	F CHAMBER	a MIS. ANGLE	ULT. STATIC RADIAL LOAD (lbs.)	Approx. Weight (lbs.)
	+ .0000 - .0005	+ .0000 - .0005	+ .005 - .005	+ .000 - .005	REF.	REF.	REF.	REF.		
HIN6T	.3750	.9060	.813	.345	.512	.781	.030	23	16,983	.068
HIN7T	.4375	1.0000	.875	.345	.618	.875	.030	22	19,032	.095
HIN8T	.5000	1.1250	.937	.401	.730	1.000	.030	20	25,275	.160
HIN10T	.6250	1.3750	1.200	.567	.856	1.250	.030	20	44,652	.245
HIN12T	.7500	1.5625	1.280	.620	.970	1.375	.035	18	53,716	.315